

### Models-1071, 1072, 1073, 1074. Aluminium Case & Brass Internals

**Case**

Aluminium. Stove enamelled finish.

**Socket + Element**

Brass / Phosphor Bronze

**Thread**

1/8", 1/4", 3/8", 1/2" NPT, BSP, BSPT

**Movement**

Brass

**Dial**

White Aluminium (Black Printing)  
Fine scale markings  
Anti parallax mirror band

**Pointer**

Black Aluminium (Knife edge)

**Window**

Sheet Glass

**Standard Size**

150, 250mm

**Accuracy class**

0.25% or 0.5% of Full scale  
Over 1600 bar on rising pressure only.

**Scale Range**

150, 250mm Vacuum to 2,000 bar  
Calibration certificate is issued for each gauge  
showing increasing and decreasing readings  
against Dead - Weight Testers

**Ordering information**

State:- Pressure gauge model  
/ Nominal size / Scale range  
/ Size and location of connection / Optional extras reqd

**Optional extras**

Other pressure connections (including high pressure).  
Monel to Nace MR-01-75 wetted parts.  
Laminated safety glass / Perspex window.

**Further options: on request**



Model - 1072

We manufacture a wide range of instruments to customer's special requirements  
We shall be pleased to discuss and advise on your specifications.

Specifications and dimensions given in this leaflet represent the state of engineering at the time of printing.  
Engineering modifications may take place without prior notice.

**STEWART-BUCHANAN GAUGES LTD**  
Sales Office & Manufacturing Facility.  
Burnside Industrial Estate, Kilsyth, Glasgow, G65 9JX, SCOTLAND  
Tel:- +44 (0)1236 821533  
Fax:- +44 (0)1236 824090  
E-Mail:- sales@stewarts-group.com  
Web Site:- www.stewarts-group.com

## Models-1071, 1072, 1073, 1074. Aluminium Case & Brass Internals

Surface Mounted  
Model - 1071

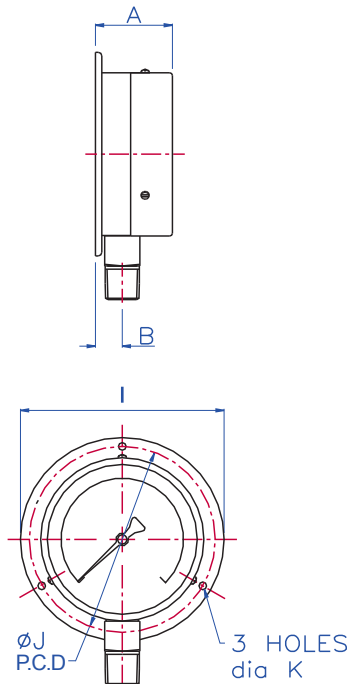

Direct Mounted  
(Standard)  
Model - 1072

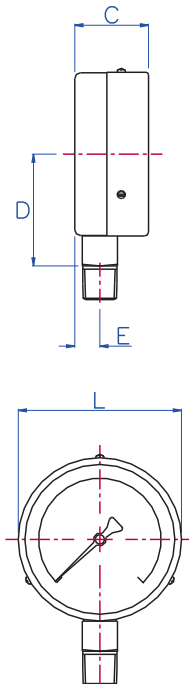

Flush Mounted  
Screw Fixing  
Model - 1073

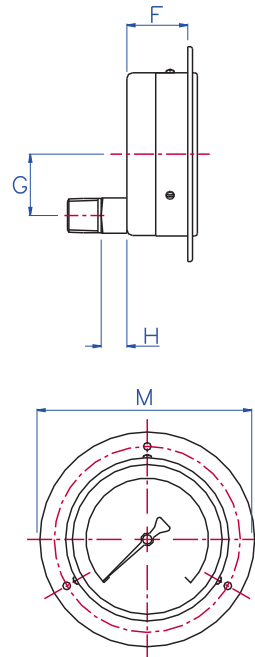

Flush Mounted  
Clamp Fixing  
Model - 1074

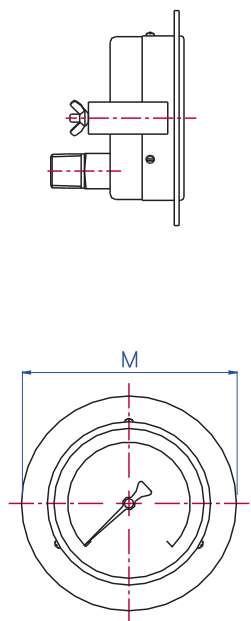

Dimensions Diameter	A	B	C	D	E	F	G	H	I	J	K	L	M	Panel Cut-out
150	50	19	45	93	14	39	32	18.5	178	168	5	152	185	165
250	55	17	55	148	17	49	52	16	290	273	6.5	256	302	270