

Maximum flow ranges from	4-200 GPM (22-750 LPM)	CP-V8
Max pressure	300 PSI (20 Bar)	Battery operated
Temperature range	32-210°F (2-99°C)	

# UNIVERSAL<sup>®</sup> Flow Monitors

## Vortex Shedding Flowmeter

# CoolPoint<sup>™</sup>



### Description

This flowmeter is made for water and low viscosity fluids.

It has the following features:

- Battery operated (AA batteries).
- Rate or Total
- No moving parts to clog or wear
- 6 1/2 digit LCD display

### Material Specifications

Flow bodies of brass or 316 Stainless Steel with PVDF sensors and Viton<sup>®</sup> seals standard. PEEK sensors used for high temp for fluids above 150° F.

### User-Configurable Options

Features that are selectable include:

- Selectable units: Gallons, Liters or Cubic Meters.

### Instrument Specifications

- Flow
  - Accuracy:  $\pm 2\%$  of full scale
  - Repeatability:  $\pm .25\%$  of indicated flow
  - Turndown (ratio of max to minimum flow rates): 10:1
- Pressure
  - 300 PSIG (20 Bar) operating pressure
- General
  - Fluid temperature limits: 35-150° F (2-66° C) standard, 150-210° F (66-99° C) optional.
  - Enclosure rating: Type 1, 3, 4, 12 and 13
- Pipe Connections:
  - Female NPT, BSPP & BSPT
- Back pressure of 10 PSIG required.

# How To Order *Select the appropriate symbols to build a model code:*

## MODEL CODES

Flow maximum GPM (LPM)	Pipe size inches	Model code	Material	Thread options available
4 (15)	1/4	<b>CP2-V8</b>	-M1*=Brass	T1*=NPT
6 (22.7)	3/8	<b>CP3-V8</b>	-M2=316 Stainless Steel	T2=BSPT
12 (45)	1/2	<b>CP4-V8</b>		T3=BSPP
25 (95)	3/4	<b>CP6-V8</b>		
50 (190)	1	<b>CP8-V8</b>		
100 (380)	1 1/2	<b>CP12-V8</b>		
200 (750)	2	<b>CP16-V8</b>		

\*\* Use schedule 40 pipe only

\* Indicates default selection. If no selection is made, this option is assumed.

**Example:** CP2-V8 is the same as CP2-V8M1T1

## PRESSURE DROP

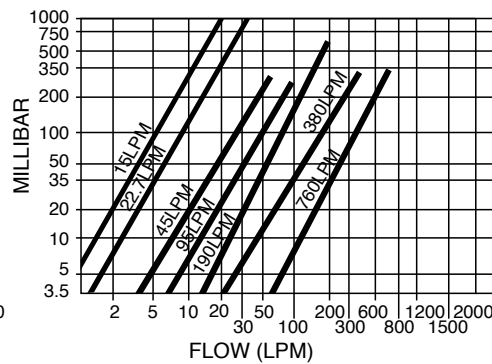
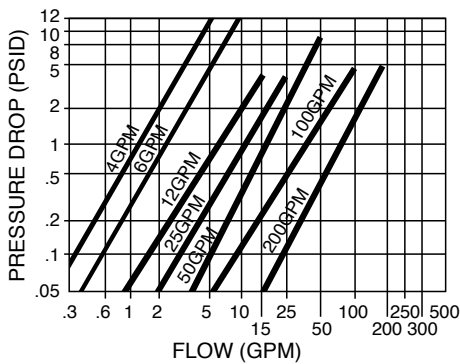

## INSTALLATION DRAWINGS

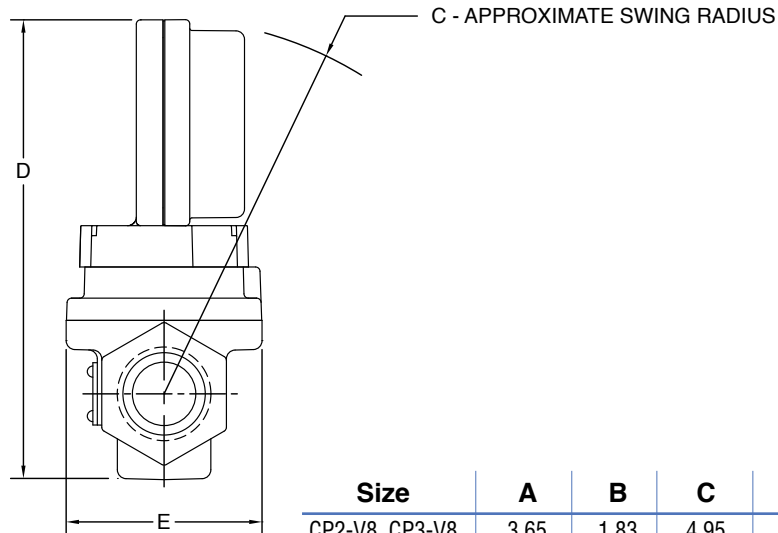
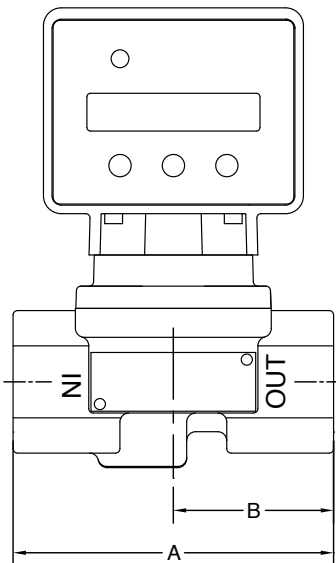

Size	A	B	C	D	E
CP2-V8, CP3-V8 & CP4-V8	3.65 [93mm]	1.83 [46mm]	4.95 [126mm]	5.91 [150mm]	2.37 [60mm]
CP6-V8 & CP8-V8	4.50 [114mm]	2.25 [57mm]	5.26 [134mm]	6.44 [163mm]	2.75 [70mm]
CP12-V8 & CP16-V8	6.75 [171mm]	3.38 [86mm]	5.99 [152mm]	7.69 [195mm]	2.88 [73mm]