

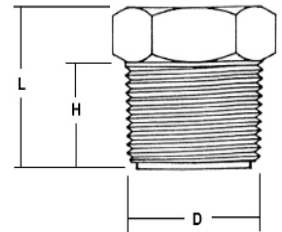

TECHNICAL SPECIFICATIONS

- Easily removed for cleaning
 - 316 stainless steel diaphragm and machined plug
 - Welded diaphragm
 - Standard "fill" fluid non-toxic silicon oil, Dow Corning 200 Fluid 100CS
 - Fitted with a filling plug for correct calibration after vacuum evacuation
 - Comprehensive range of other designs to suit all industries
 - Accuracy (by dial size): 63mm : 2.5%, 100mm & 150mm : 1.5%
- Designed and manufactured in Australia

Nominal Plug Size	316 S/S Diaphragm	Minimum Pressures		Dimensions		
		63 & 100mm	150mm	L	H	D
1" (25mm)	27mm Diameter	250kPa	800kPa	39	23	31.5
1.25" (32mm)	27mm Diameter	100kPa	600kPa	39.5	24	40
1.5" (40mm)	40mm Diameter	100kPa	250kPa	43	28.5	47
2" (50mm)	40mm Diameter	100kPa	250kPa	48	29	59



ORDERING CODE

PS2000 - 24T - 6P (Example Only)

Model

PS2000

Process Connection

1" BSPT 16T
1" NPT 16N
1.25" BSPT 20T
1.25" NPT 20N
1.5" BSPT 24T
1.5" NPT 24N
2" BSPT 32T
2" NPT 32N

4T 1/4"BSPT
6P 3/8"BSPP
8N 1/2"NPT
8P 1/2"BSPP

Instrument Connection

Sales of ALL products are subject to our General Conditions of Quotation & Supply.
Technical specifications are subject to change without prior notice.