

40mm Series

Stainless / Brass Pressure Gauges

40mm glycerine fillable pressure gauge with stainless steel case.
General purpose gauge to suit many applications throughout a broad range of industries.

FULLY COMPLIES WITH THE ACCURACY REQUIREMENTS OF A.S. 1349

Case & Bezel

AISI 304 Stainless steel, glycerine fillable

Mounting

Direct Rear Model 525
Panel via Clamp Model 524

Window

Plexiglass

Dial

Aluminium, white, dual scale, kPa outer in black, psi inner in red

Pointer

Aluminium with black finish

Bourdon Tube

Phosphor Bronze

Movement

Brass

Socket (connection)

Brass: 1/8" BSPT & 1/8"NPT (0/1000kPa)

Accuracy

+/-3% F.S. Complies with AS1349-1986

Dial Size

40mm

Restrictor

Included



Model 525

STANDARD kPa SCALE RANGES and ORDERING CODES

Model/Mounting:

Direct Rear Entry 525
Panel via rear clamp 524

Dial Size in mm:

525
524

040

525 - 040 - 75 - 2T - G

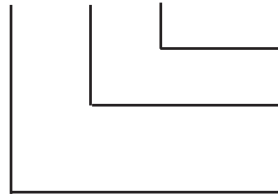

Liquid Filled Case

G GLYCERINE *

Connection

2T 1/8"BSPT
2N 1/8"NPT

Range:

75 Example only
Stocked Range Codes refer Table

***WARNING:** Do not use glycerine filled gauges in any service which may include strong oxidising agents including (but not limited to) Chlorine, Nitric Acid, Hydrogen Peroxide. Such combinations can result in an explosion

DIMENSIONS mm

Range kPa (psi)	Order Code
0 - 100 (0-14)	69
0 - 250 (0-36)	72
0 - 400 (0-58)	73
0 - 1000 (0-140)	75

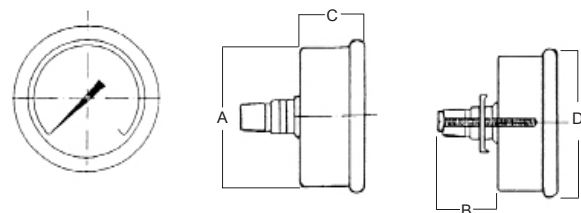

A	B	C	D
41	19	25	46.5

Sales of ALL products are subject to our General Conditions of Quotation & Supply.
Technical specifications are subject to change without prior notice.

AMBIT INSTRUMENTS PTY LTD

ABN No 50 005 613 641

42 TITAN DRIVE CARRUM DOWNS Vic 3201 AUSTRALIA.

Phone: 03.9776.8888 Fax: 03 9776.8656

Email: contact@ambitinst.com.au

www.ambitinst.com.au

08/17

NATA ENDORSED CALIBRATION
CERTIFICATES AVAILABLE

