

AMBIT

CONTENTS/LEVEL GAUGES

THE GAUGES

THIS FAMILY OF ANALOGUE INDICATORS PROVIDES A UNIQUE, ACCURATE AND COST EFFECTIVE SOLUTION FOR REMOTE LIQUID MEASUREMENT AND CONTROL. USING HYDROSTATIC TECHNOLOGY TO OBTAIN THEIR READINGS AND SO REQUIRE NO POWER SUPPLY, THEY ARE ACTUATED VIA A BALANCE CHAMBER THAT IS INSTALLED THROUGH THE TANK TOP AND CONNECTED TO THE GAUGE VIA CAPILLARY TUBING. OPERATION OF THE INTEGRAL HANDPUMP LOCATED IN THE FRONT OF THE GAUGE DISPLACES THE LIQUID FROM THE BALANCE CHAMBER, RESULTING IN A BACK PRESSURE THAT IS INDICATED ON THE GAUGE DIAL WHICH (DEPENDING ON MODEL), CAN BE CALIBRATED IN DEPTH, WEIGHT, VOLUME, OR OTHER ENGINEERING UNITS.

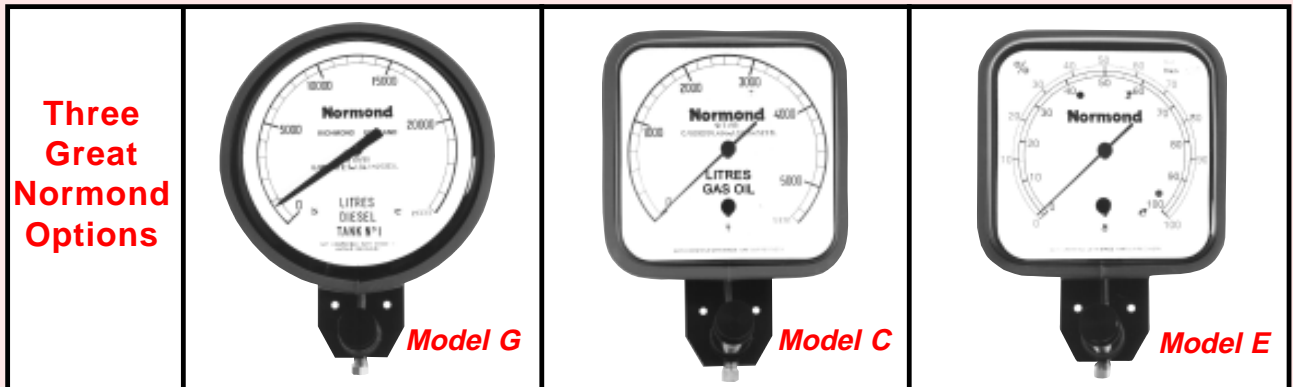

BASIC FEATURES	<p>MODEL G gauge has a robust beryllium copper bellows held within a rugged temperature compensated frame. This is linked to a Swiss rack and pinion movement fitted with overload stops ensuring both linearity and high levels of accuracy. When used for monitoring dangerous or volatile liquids, we recommend optional "fail to full" calibration to minimise the risk of overfills. Calibration certificates are supplied on request.</p>	<p>The MODELS C & E are capsule actuated non temperature compensated gauges and offer a lower cost alternative for remote liquid measurement and control</p>	
		<p>MODEL C gauges are individually factory calibrated to specific tank data supplied by the customer. The contents, tank number and product identification can also be displayed on the dial of the gauge.</p>	<p>MODEL E gauges are fitted with a special adjustment feature that enables them to be calibrated "on-site" by the customer. They have dual scales (red and black) each marked 0-100% for either vertical or cylindrical (non-linear) horizontal tanks.</p>

DIAL SIZE	150mm, 200mm & 300mm	Scale Diameter is 150mm (nominal)	
CASE MATERIAL	A.B.S. (Plastic)		
PRESSURE RANGE	Any from 0 - 1 Metre water to 0 - 9.2 Metre water		
TRANSMISSION DISTANCE	Up to 120 Metres between gauge and tank		
CALIBRATION	Factory Calibrated		On Site: Reading is 0 - 100% only
ACCURACY	1.0%	2.0%	5.0%
FAIL TO FULL OPTION	Available		No
CONTINUOUS READING OPTION	Yes (All models) Details on Application		
STANDARD KIT	As selected by Customer	Supplied with 10 Metres of PVC tubing standard balance chamber & tank adaptor	
LOCKABLE STEEL CABINET	Yes (All models) Details on Application		
NOTE	Not Compatible with Stage 1B Vapour Recovery		

See a working model at www.ambitinst.com.au/Level/normond.html

AMBIT Instruments Pty Ltd 42 Titan Drive Carrum Downs Vic 3201 Australia

ABN 50 005 613 641

Phone (03) 9776.8888 Fax (03) 9776.8656 Freecall (H.O.) 1800 101 102

email: contact@ambitinst.com.au website: www.ambitinst.com.au



**Sydney Sales Office: Unit 10, 272-274 Victoria St,
Wetherill Park NSW 2164 Phone (02) 9604 3544
Fax (02) 9604 3677 email: nswsales@ambitinst.com.au**



Registered Laboratory
No. 3103

BALANCE CHAMBERS

Gauges are supplied with a standard balance chamber (BC) and 10m of PVC tubing. A range of supplementary units is available to suit different fluid types and chemical products, or where high fill rates are encountered. All balance chambers are supplied with a tank adapter fitting for installation through the top of the tank.

STANDARD CHAMBER (NOT PICTURED) C & E SERIES ONLY

Construction: Brass weight, PVC connecting tube 6.4mm o/d
Max Temp: 38 deg C

Application: Tanks up to 3.0m deep for heating oils or where liquid will not attack PVC.

Minimum tank entry: .5 inches, 12.5 mm.

BALANCE CHAMBER BC1

Construction: Zinc plated steel magnetic bell, PVC connecting tube 6.4mm o/d.

Viscosity limit: 150 seconds Redwood No. 1 @ 16 deg C.

Max temp: 38 deg C

Application: Tanks up to 6m deep for heating oils, paraffin or where the liquid will not attack PVC.

Minimum tank entry: 1.5 inches, 38 mm.

BALANCE CHAMBER BC4

Construction: Rigid PVC tube.

Viscosity limit: 3,500 seconds Redwood No. 1 @ 16 deg C.

Max Temp: 38 deg C

Application: Acids etc, where metals would be attacked.

Suitable up to 9.2m head of water.

Minimum tank entry: 1 inch, 25.5 mm

BALANCE CHAMBER BC6

Construction: BC 6/1 mild steel, BC 6/4 copper, BC 6/5 stainless steel ASI 316. All rigid tube.

Viscosity limit: 3,500 seconds Redwood No. 1 @ 160deg C.

Max temp: 100 deg C

Application: General use where above materials are compatible and for deeper tanks up to 9.2m head of water.

Minimum tank entry: 1 inch, 25.5mm

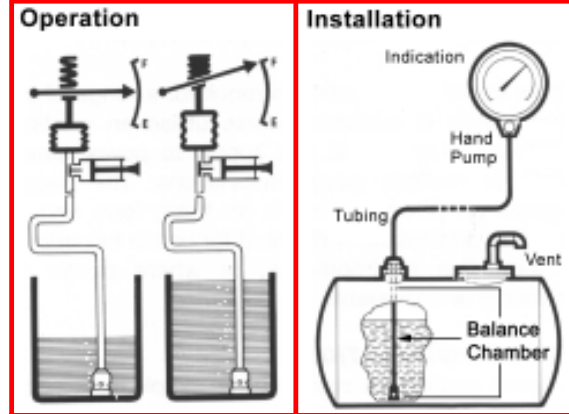
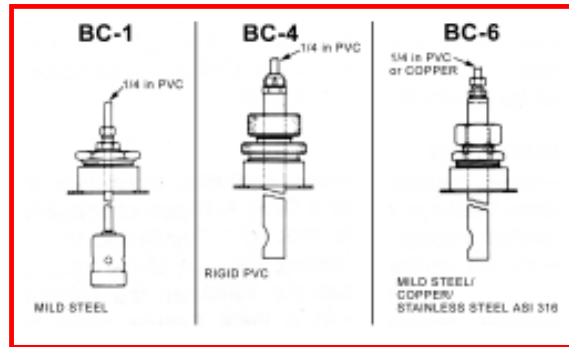

CONTINUOUS READING

Gauges can be made to read continuously by using one of the air supply units below, along with continuous reading balance chambers.

P7 AIR FILTER/REGULATOR

Regulates site compressed air to supply one gauge.

P7A SIR FILTER/REGULATOR

Regulates site compressed air to 2 gauges.

P2A AIR FILTER/REGULATOR

Regulates site compressed air to supply up to 9 gauges.

P2E CONTINUOUS AIR SUPPLY UNIT

Supplies and regulates site compressed air to supply up to 9 gauges. Requires 240v mains supply.

Dimensions Mode G

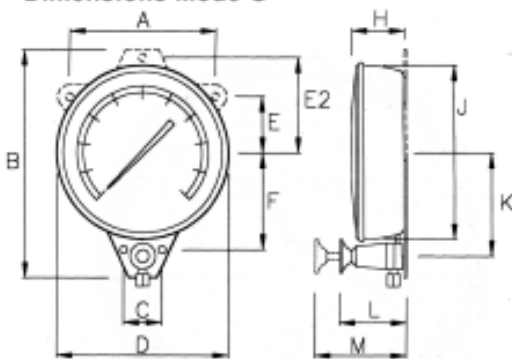

	G6	G8	G12
	150mm	200mm	300mm
A	CL	152.4	203.2
B	240	268	368
C	38	60.3	660.3
D	181	233.4	335
E	N/A	765	127
E2	96.5	N/A	N/A
F	95.5	109.3	162
H	98	101	108
J	164	215.9	317.5
K	116.5	136.2	188
L	111.1	111.1	111.1
M	148.4	148.4	148.4

Dimensions Models C & E

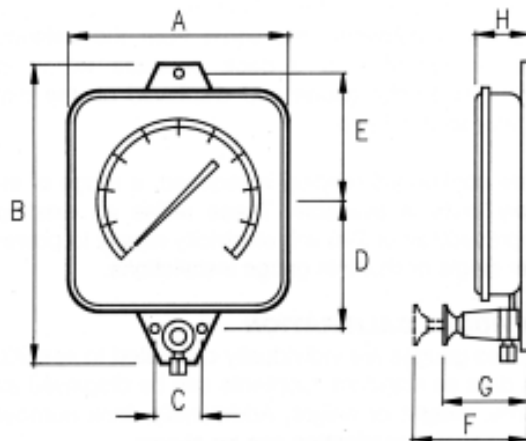

A	B	C	D	E	F	G	H
170	240	38	95.5	96.5	148	111	154